

Window Awnings

Cool your rooms, save money and add a stunning feature to your home

Why install a Window Awning?

- Reduce your energy bills**
 A window awning will keep your rooms cooler in summer and warmer in winter, so that you can turn off your air conditioner or heater and save on electricity costs.
- Stop unwanted weather reaching the window**
 No one likes scrubbing the windows! With a Lyrebird timber window awning, you won't need to as often. You'll also extend the life of your window sills and frames, as they won't be subjected to as much weather wear.
- Stop sun bleaching**
 Curtains, bed covers and cloth furnishings are expensive. Make sure that yours last longer, keeping them protected with a Lyrebird window awning.
- Are a fast and inexpensive way to add a stunning feature to your home**
 Improve the resale value of your home and enjoy the envious stares of your neighbours when you install this attractive feature to your home

"The quality of this product from workmanship to the timber just simply 'blew us away' when we unpacked it. The whole experience was outstanding and unexpected in this day and age of mass production"
 K & H Donald,
 Delighted Lyrebird Customers

- Are made to last**
 Our window awning are made using radiata pine and treated with Light Organic Solvent Preservative (LOSP) to H3 level (protection for components above the ground), to resist rotting and borers.



Door Canopy

800 x 900mm
 Roof: 950mm



Choose from 6 Window Awning profiles



Profile BA

1200 x 600mm
 Roof: 900mm



Profile BB

1200 x 600mm
 Roof: 900mm



Profile BD

1000 x 500mm
 Roof: 800mm



Profile B4

950 x 600mm
 Roof: 760mm



Profile BF

750 x 600mm
 Roof: 760mm



Profile BC

900 x 500mm
 Roof: 800mm

Your Lyrebird Distributor is:

Carports

Carports are a smart move - protecting your car and increasing the value of your home at the same time

Why have a carport built?

- **An attractive addition to your home**
Our attractive and contemporary carport designs will make your house stand out on the block for all the right reasons.
- **Protect your car**
Protect your car with a carport and save! Retain the finish of your car for longer and protect against corrosive bird leavings.
- **Add value to your home**
Increase the value of your home to prospective buyers or when re-financing.



*"Your **Smart-Arch** trusses are beautiful and my builder who put them up was very impressed with the quality. Everything fitted perfectly!"*

R Smith, Impressed Lyrebird Customer

Choose from 4 Carport roofing profiles and 2 standard sizes

Standard - Width 3.0m x Depth 5.3m

Double - Width 5.5m x Depth 5.3m

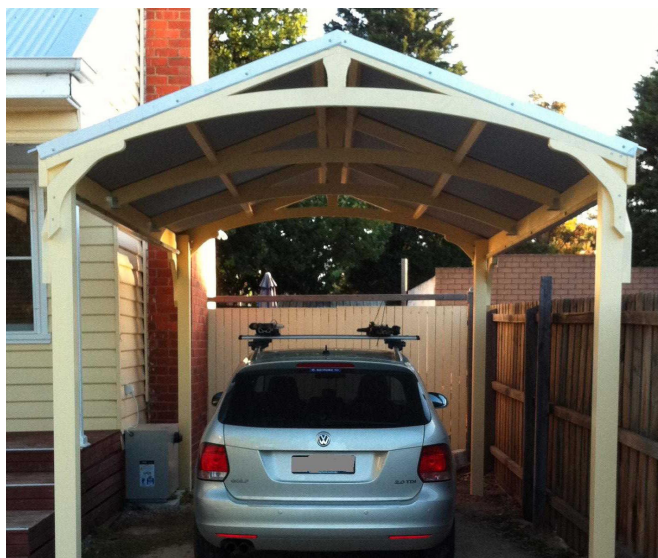
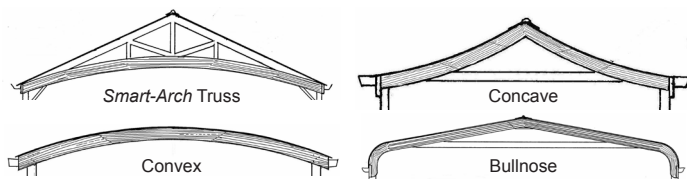

Review all our designs at:

www.lyrebird.com.au